

# Wakaflex®

## General Installation Rules

- 1 Please ensure Wakaflex® is only laid on dry and dust-/oil-/fat-/silicone- and ice-free surfaces.
- 2 Please ensure, that the non-supported gap between tiles and any rising building parts is less than 50mm; otherwise install additional support.
- 3 Wakaflex® has to be attached to the roofing material only at the edge area where the butyl strip is located (attach properly).
- 4 For profiled tiles the sided overlap of Wakaflex® has to follow over the next hip to the end of the water channel. With plain tiles the sided overlap has to be at least 120mm (Recommended application as soakers).
- 5 Ridge-sided applications have to be done on plain support (e.g. formwork, flat roofing material).
- 6 The minimum overlap of two pieces of Wakaflex® (e.g. for extending) have to be at least 50mm. Don't implement the joint against the water course.
- 7 Water sags and standing water have to be avoided.
- 8 Wakaflex® has to be mechanical fixed properly at rising building parts.
- 9 Additional components (e.g. chimney or wall cladding) must not apply tension on Wakaflex® after the installation.
- 10 Wakaflex® is not compatible with the following substances: Bitumen, tar, turpentine, petrol, fat, nitro-paint thinner, oil, hydrochloric-acid, tetrahydrofuran.

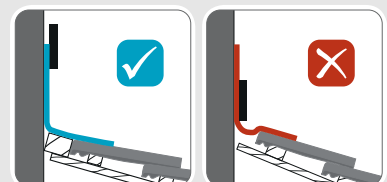
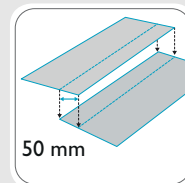
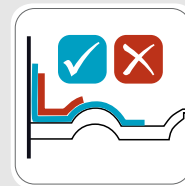
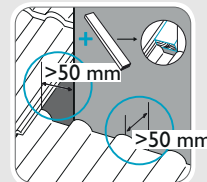

### Contact

**Haus Profi**  
Unit 6F, East Midlands Distribution Centre, Short Lane,  
Castle Donington, Derbyshire, DE74 2HA, UK  
tel: 0845 600 4427 | email: [info@haus-profi.co.uk](mailto:info@haus-profi.co.uk)  
fax: 01332 813 082 | [www.roof-flashing.info](http://www.roof-flashing.info)



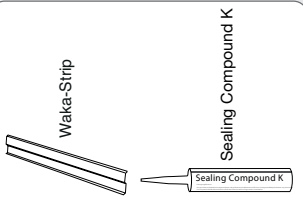
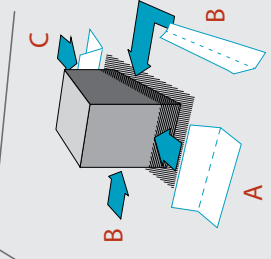
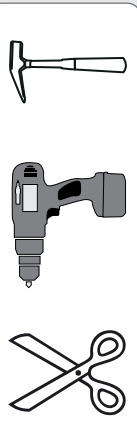

	a	b	c	d
$>22^\circ$	80	150	100	100
$>15^\circ - 22^\circ$	100	150	100	150
$7^\circ - 15^\circ$	100	150	100	200

\*Please note the general rules for Wakaflex®

